

3#齿轮箱出轴直径 $\phi$ 28mm配单相电机技术参数  
**3# GEARBOX WITH SHAFT DIA  $\phi$ 28mm WITH 1-PHASE MOTOR PARAMETERS**

3#齿轮箱出轴直径 $\phi$ 28mm配单相电机技术参数  
**3# GEARBOX WITH SHAFT DIA  $\phi$ 28mm WITH 1-PHASE MOTOR PARAMETERS**

卧式 HORIZONTAL 立式 VERTICAL



■卧式 Horizontal

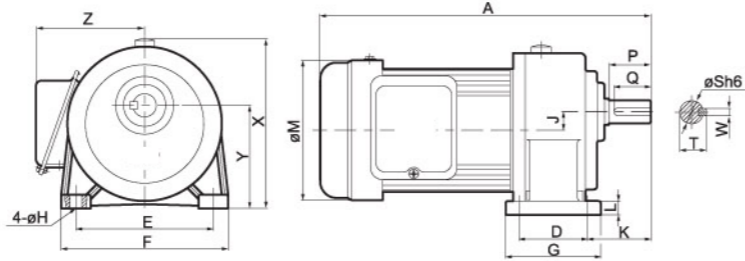

■立式 Vertical

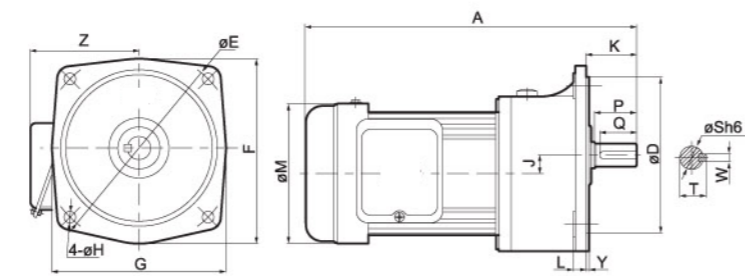

■高速比 (1#+3#) HIGH RATIO (1#+3#)



■卧式 Horizontal

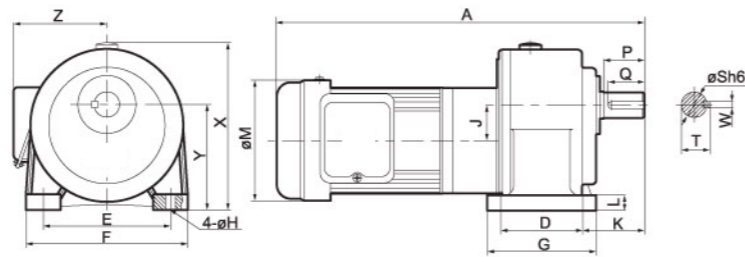

■立式 Vertical

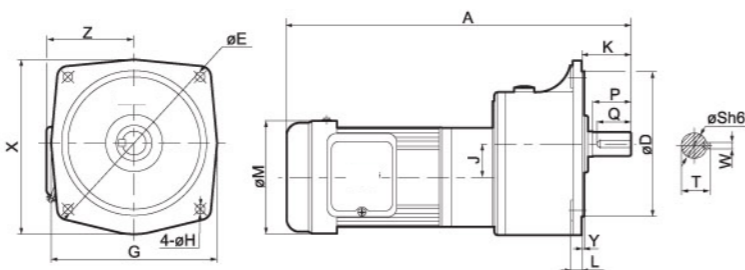

■尺寸表 Size Table

单位Unit: mm

功率Power	减速比Ratio	A	D	E	F	G	H	J	K	L	M	X	Y	Z	S	P	Q	W	T	重量Weight
100W 1/8HP	标准型250~1800 (1#+3#)	370	90 (170)	140 (220)	178 (205)	120 (195)	12	39	68 (58)	17 (13)	133	178 (/)	116 (3)	120	28	45	40	7	31.1	14.5
	/	/	/	/	/	/	/	/	/	/	/	/	/	/	/	/	/	/	/	/
200W 1/4HP	标准型100~200	350	90 (170)	140 (220)	178 (205)	120 (195)	12	23	68 (58)	17 (13)	133	178 (/)	116 (3)	120	28	45	40	7	31.1	9.0
	缩框型250-1800 (1#+3#)	410	90 (170)	140 (220)	178 (205)	120 (195)	12	39	68 (58)	17 (13)	167	178 (/)	116 (3)	120	28	45	40	7	31.1	18.0
400W 1/2HP	标准型15~90	360	90 (170)	140 (220)	178 (205)	120 (195)	12	23	68 (58)	17 (13)	167	178 (/)	116 (3)	135	28	45	40	7	31.1	14.0
	缩框型100-200	360	90 (170)	140 (220)	178 (205)	120 (195)	12	23	68 (58)	17 (13)	167	178 (/)	116 (3)	135	28	45	40	7	31.1	14.0
750W 1HP	标准型3~25	380	90 (170)	140 (220)	178 (205)	120 (195)	12	23	68 (58)	17 (13)	167	178 (/)	116 (3)	135	28	45	40	7	31.1	16.0
	缩框型30-120	380	90 (170)	140 (220)	178 (205)	120 (195)	12	23	68 (58)	17 (13)	167	178 (/)	116 (3)	135	28	45	40	7	31.1	16.0
1500W 2HP	/	/	/	/	/	/	/	/	/	/	/	/	/	/	/	/	/	/	/	/
	缩框型3-30	420	90 (170)	140 (220)	178 (205)	120 (195)	12	23	68 (58)	17 (13)	192	178 (/)	116 (3)	135	28	45	40	7	31.1	25.0

※表中( )内为立式电机尺寸。

※labulation "( )" denote Vertical motor dimension.

■输出轴容许扭矩Output Torque

单位Unit: kg-m

功率Power	标准型 Standard type	缩框型 Light duty type	速比 Ratio																				
			3	5	10	15	20	25	30	40	45	50	60	70	80	90	100	120	140	160	180	200	
200W 1/4HP	50Hz	/	/	/	/	/	/	/	/	/	/	/	/	/	/	/	/	11.5	13.8	16.0	18.3	20.7	22.9
	60Hz	/	/	/	/	/	/	/	/	/	/	/	/	/	/	/	/	9.60	11.5	13.4	15.3	17.3	19.1
400W 1/2HP	50Hz	/	/	/	3.60	4.80	6.00	7.20	9.30	10.9	11.6	13.9	16.2	18.4	20.7	/	/	/	/	/	/	/	/
	60Hz	/	/	/	3.00	4.00	5.00	6.00	7.80	9.10	9.70	11.6	13.5	15.4	17.3	/	/	/	/	/	/	/	/
750W 1HP	50Hz	1.30	2.20	4.50	6.80	9.00	11.2	/	/	/	/	/	/	/	/	/	/	/	/	/	/	/	/
	60Hz	1.10	1.90	3.80	5.70	7.50	9.40	/	/	/	/	/	/	/	/	/	/	/	/	/	/	/	/
1500W 2HP	50Hz	2.96	4.94	9.88	11.2	11.2	11.2	/	/	/	/	/	/	/	/	/	/	/	/	/	/	/	/
	60Hz	2.47	4.12	8.23	11.2	11.2	11.2	/	/	/	/	/	/	/	/	/	/	/	/	/	/	/	/

■高速比输出轴容许扭矩 (1#+3#) High Ratio Output Shaft Torque (1#+3#)

单位Unit: kg-m

功率Power	标准型 Standard type	缩框型 Light duty type	速比 Ratio																			
			250	300	350	400	450	500	600	700	800	900	1000	1100	1200	1300	1400	1500	1600	1700	1800	
100W 1/8HP	50Hz	11.2	11.2	11.2	11.2	11.2	11.2	22.9	22.9	22.9	22.9	22.9	22.9	22.9	22.9	22.9	22.9	22.9	22.9	22.9	22.9	22.9
	60Hz	11.2	11.2	11.2	11.2	11.2	11.2	22.9	22.9	22.9	22.9	22.9	22.9	22.9	22.9	22.9	22.9	22.9	22.9	22.9	22.9	22.9
200W 1/4HP	50Hz	11.2	11.2	11.2	11.2	11.2	11.2	22.9	22.9	22.9	22.9	22.9	22.9	22.9	22.9	22.9	22.9	22.9	22.9	22.9	22.9	22.9
	60Hz	11.2	11.2	11.2	11.2	11.2	11.2	22.9	22.9	22.9	22.9	22.9	22.9	22.9	22.9	22.9	22.9	22.9	22.9	22.9	22.9	22.9