

调速电动机 SPEED CONTROL MOTORS

180W

□ 104mm

CE CCC RoHS ISO9001

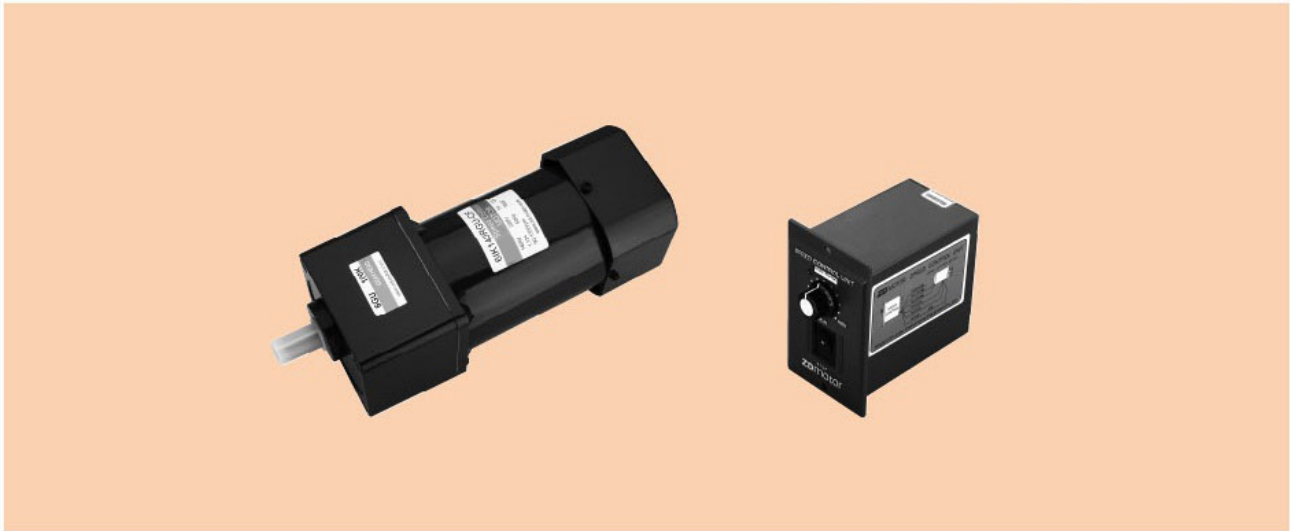

规格 / 连续额定 SPECS / CONTINUOUS RATING

品名 Model 导线型 Lead Wire Type	机型 Type Pinion Shaft / 圆轴型 Round Shaft	输出功率 Output power W	电压 Voltage V	频率 Frequency Hz	调速范围 Speed Control Range r/min	额定转矩 Rated Torque		启动转矩 Starting Torque mN.m	电流 Current A	电容器容量 Capacitor μ F
						120r/min mN.m	120r/min mN.m			
6IK180RGU-CF	6IK180RA-CF	180	1ph220 1ph230	50	90~1400	920	500	700	1.40	12
6IK180RGU-HF	6IK180RA-HF	180	1ph220 1ph230	60	90~1700	920	500	700	1.40	

- 各种安全规格以电动机铭牌上的型号取得认定。
- When the motor is approved under various safety standards, the model name on the nameplate is the approved model name.

种类 TYPE

● 电动机 MOTOR

机型 Type	型号 Model	
	齿轮轴型 Pinion Shaft	圆轴型 Round Shaft
导线型 Lead Wire Type	6IK180RGU-CF	6IK180RA-CF
	6IK180RGU-HF	6IK180RA-HF

● 平行轴减速器(另售) PARALLEL SHAFT GEARHEAD (SOLD SEPARATELY)

减速器种类 Gearhead Type	减速器型号 Gearhead Model	减速比 Gear Ratio
长寿命·低噪音 Long Life · Low Noise	6GU□K	3、3.6、5、6、7.5、9、 12.5、15、18、25、30、 36、50、60、75、90、 100、120、150、180、200

- 减速器型号的□中为减速比的数值
- Enter the gear ratio in the box (□) within the model name

A C 交流调速电动机

说明 Explain

感应电动机 Induction Motor

可逆电动机 Reversible Motors

刹车电动机 Brake Motors

调速电动机 Speed Control Motors

转矩电动机 Torque Motors

■ 装有减速器时的容许转矩

ALLOWABLE TORQUE WHEN BEING WITH GEARHEAD

- 减速器·中间减速器另售
- 减速器型号的□中为减速比的数值。
- □色表示与电动机同一方向运转，其他则为相反方向。
- 转速是以电动机的同步转速 (50Hz: 1500r/min、60Hz: 1800r/min) 为基准除以减速比而算出来的数值。实际转速将随负载大小变化而比所示数值减少 2%~20%左右。
- Gearhead and mid-gearbox can be sold separately.
- Enter the gear ratio in the box (□) within the model name.
- The colored background □ indicates the same rotating direction of the motor while the rotating direction of others are opposite.
- The speed is calculated by dividing the motor's synchronous speed (50Hz: 1500r/min、60Hz: 1800r/min) by the gear ratio. The actual speed is 2%~20% less than the displayed value, depending on the size of the load.

容许力矩单位 Allowance Torque Unit: 上段 Upside (N.m) / 下段 Belowside (kgf.cm)

机型Type 电动机/减速器 Motor/Gearhead	减速比Gear Ratio	容许力矩																					
		3	3.6	5	6	7.5	9	12.5	15	18	25	30	36	50	60	75	90	100	120	150	180	200	
6IK180RGU-CF	50Hz	500	417	300	250	200	166	120	100	83	60	50	41	30	25	20	16	15	12.5	10	8.3	7.5	
	60Hz	600	500	360	300	240	200	144	120	100	72	60	50	36	30	24	20	18	15	12	10	9	
6IK180RGU-HF	50Hz	□	3.4	4.0	5.6	6.7	8.4	10.1	12.6	15.2	18.2	22.8	27.4	32.9	40	40	40	40	40	40	40	40	40
		□	34.6	40.8	57.1	68.3	85.6	103	128	155	185	232	279	335	400	400	400	400	400	400	400	400	400
	60Hz	□	2.7	3.3	4.5	5.4	6.8	8.2	10.2	12.3	14.7	18.5	22.2	22.6	37	40	40	40	40	40	40	40	40
		□	27.5	33.6	45.9	55.1	69.3	83.6	104	125	150	188	226	271	377	400	400	400	400	400	400	400	400

■ 容许悬挂负载·容许轴向负载

PERMISSIBLE OVERHUNG LOAD AND THRUST LOAD

电动机 (圆轴型) → P217页
减速器 → 217页

Motor (Round Shaft) → P217
Gearhead → P217

■ 减速器的容许负载惯性惯量 J

PERMISSIBLE LOAD INERTIA J FOR GEARHEAD

→ 218页 → P218

■ 外形图 (单位 mm)

DIMENSIONS (Unit mm)

减速器附有安装用螺丝

Mounting screws are included with gearhead.

● 导线型 Lead wiring Type

重量 Weight: 电动机 Motor 5.1kg 减速器 Gearhead 2.1kg

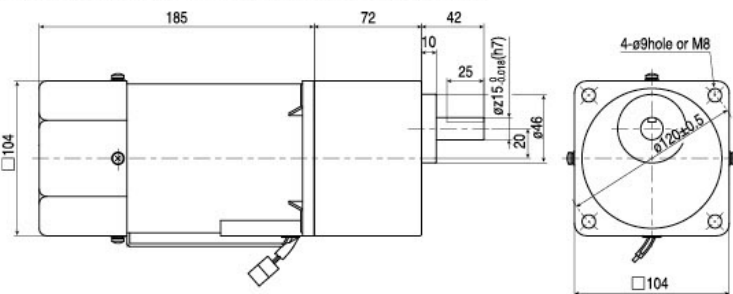

电动机型号 Motor Model	减速器型号 Gearhead Model	减速比 Gear Ratio	L1
6IK180RGU-CF	6GU□K	3-200	72
6IK180RGU-HF			

- 减速器型号的□中为减速比的数值
- Enter the gear ratio in the box (□) within the model name

● 圆轴型的转轴部分 Shaft Section of Round Shaft Type

除重量及轴部外, 电动机外形与齿轮轴相同

Excluding weight and the shaft section Motor shape are the same as those of the pinion shaft

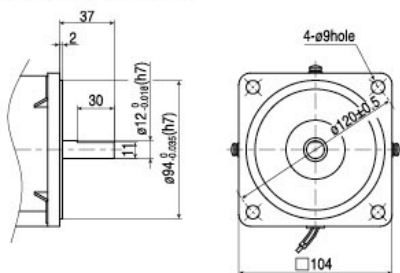

● 键·键槽 (减速器附件)

Key-keyway (The key is included with the gearhead)

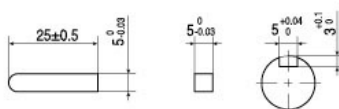

■ 连接图 CONNECTION DIAGRAMS

